

LFO-18-d

TECHNICAL DATA

Fiber Coupled Laser Diode

Description:

LFO-18-d - is a series of optical module on the base of uncooled Mitsubishi 1550 nm MQW InGaAsP/InP coupled with singlemode SMF-28 optical fiber. Hermetically sealed modules are performed in standard coaxial package with built-in driver and collimating microlens. The low operating voltage and current levels enable to use portable power supply. The modules operate in wide temperature range, have stable output power and lifetime more than $5 \cdot 10^4$ hours

Specification (Tc = 25°C)

Characteristics	Symbol	Test condition	Min	Typ	Max	Unit
Optical parameters						
Optical Output Power (fiber end)	P _o	cw	0.8	1.0		mW
Lasing Wavelength	λ _p	P _o	1530	1550	1570	nm
Spectral Width (FWHM)	Δλ	P _o		1.0	2.5	nm
Optical fiber						
Fiber Core/Cladding Diameter	D _C /D _{CL}			9/125		μm
Connector				FC		
Electronical parameters						
Operating Mode				cw		
Operating Voltage	V _{op}	P _o	2.85	3.0	3.15	V
Operating Current	I _{op}	P _o			70	mA
Reverse Polarity Protection				yes		
Climatic parameters						
Operating Temperature	T _{op}		-10		+40	°C
Storage Temperature	T _{stg}		-20		+70	°C



PACKAGE DIMENSIONS:

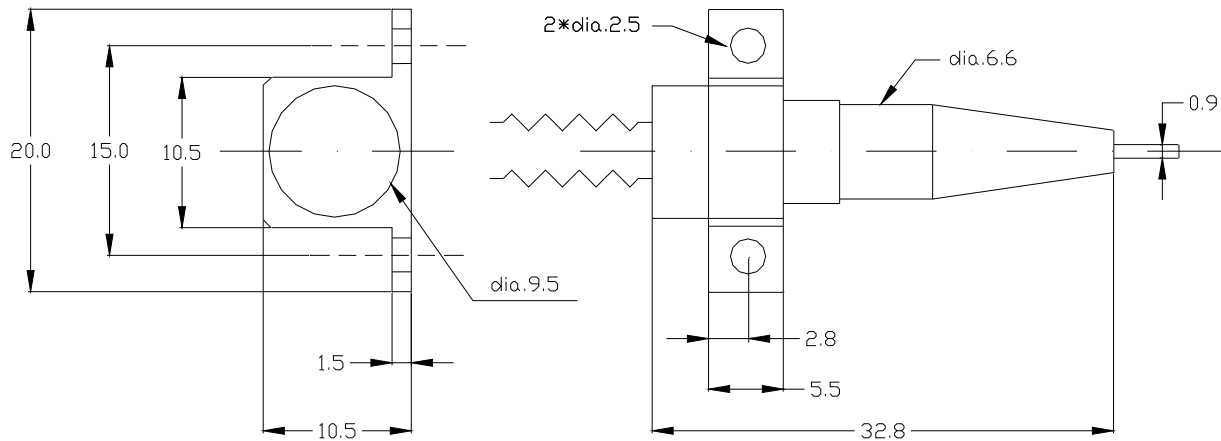

PIN	Function
black	"-" VDC
red	"+" VDC, LD anode, case